

RETAIL STORE

Property Reference: **HIGH STREET STORE**
Unit 01 - Ground Floor
Net Internal Area Plan

	RETAIL	928.4 sq m	9989 sq ft
	STORAGE	0 sq m	0 sq ft
	ANCILLARY	109.1 sq m	1173 sq ft

TOTAL AREA: 1037.5 sq m 11163 sq ft

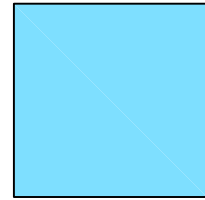
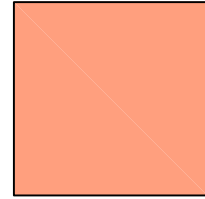
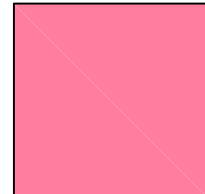

Terrain Surveys Ltd
 Bridge Chambers
 28a High Street
 Welwyn
 Herts
 AL6 9EQ
 Tel 01438 841300
 Fax 01438 841301
 enquiries@terrainsurveys.co.uk
 www.terrainsurveys.co.uk

Land and Architectural Surveyors

Client

HIGH STREET STORE

Project

HIGH STREET STORE

Title

GROUND FLOOR

Drawn by
NAA

Checked by
CDW

Scale
1:100

Date

Drawing Number **EXAMPLE**

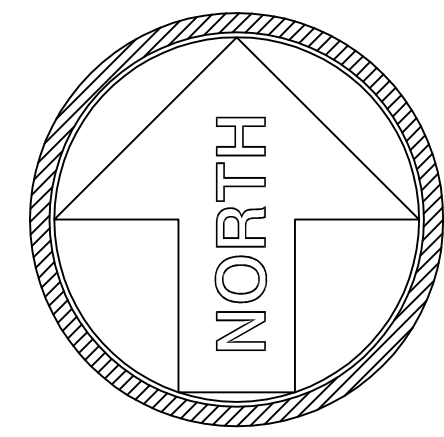

Fit Mark

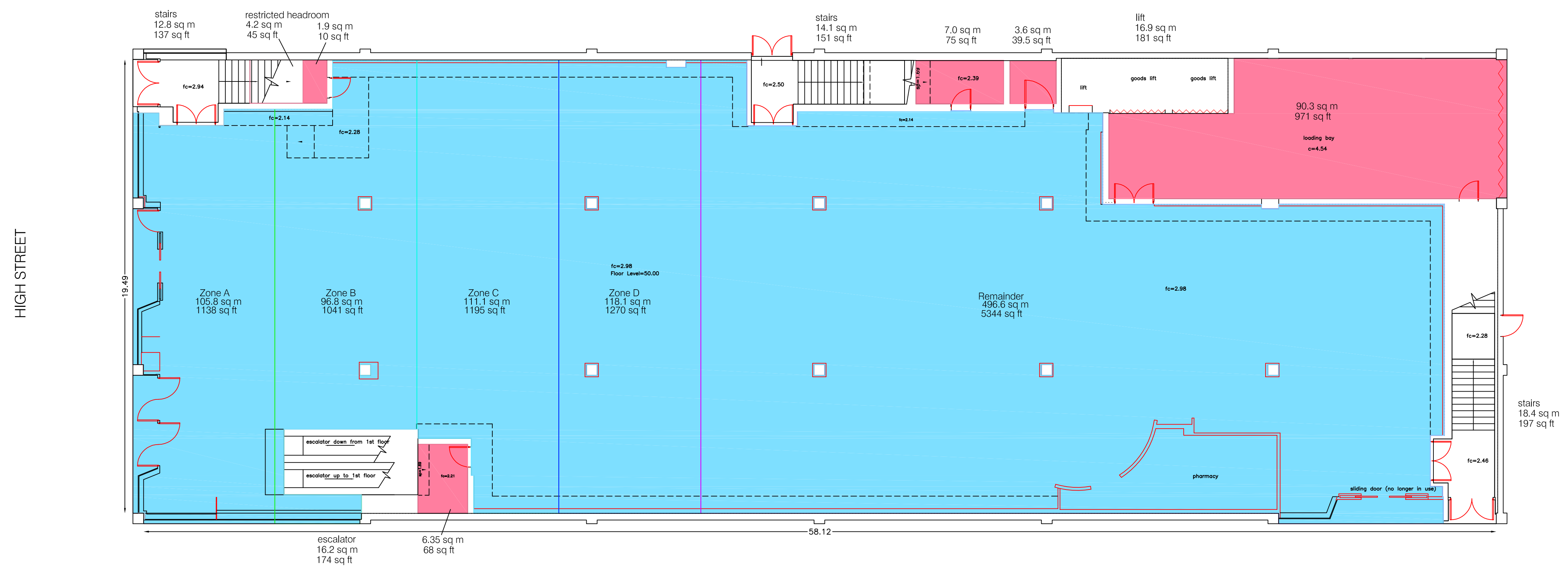

GIA
 1155.2 sq m
 12024 sq ft
 NIA
 1037.5 sq m
 11163 sq ft

Fit Mark

GROUND FLOOR